



radura® PARTS | EN | 2023

**radura®**

**GROUP SCHUMACHER**



**radura®  
is multifaceted.**

**radura®  
fits.**

**radura®  
cuts reliably.**



**radura® PARTS**



The **radura®** brand is the specialist for cutting haulms and for chopping straw and forage. Components in the area of cutting and chopping significantly support the overall performance of agricultural machinery. Often they are subject to high degrees of wear and as a result need to be exchanged regularly.

The **radura®** product range offers high-quality and custom-fit spare parts: knife sections, guards, sectional knives and straw chopper knives, rotor blades and accessories.

**radura® PARTS**

<b>radura®</b> rotary disc mower blades	4 - 5
<b>radura®</b> sectional knives	6 - 9
<b>radura®</b> knife sections	10 - 11
<b>radura®</b> guards	12 - 13
<b>radura®</b> knife heads	14 - 15
<b>radura®</b> straw chopper knives	16 - 19
<b>radura®</b> straw chopper blade attachment	20 - 21
<b>radura®</b> Online product finder	22 - 23



## The radura® rotary disc mower blades



**radura® rotor blades** translate into a high ha/hr performance and clean and uniform cuts. A special cold rolling production pro-

cess gives **radura®** rotor blades extra hard edges that offer a substantially longer service life than traditional ground edges.

### The first choice of professional users

- **Substantially higher resistance to wear** using cold-rolled cutting edges
- **Long-lasting sharpness** for clean cuts and high yields
- **Maximum reliability** – quality controlled to DIN 11250 / ISO 5718-2
- **Optimum protection from corrosion**

### Choose between three designs

- Flat
- Bent
- Twisted



## radura® sectional knives



The **radura® sectional knives** suit all major cutting systems that use forged guards. Each section is made up of a system of standardised head sections and central sections. The cutting width is obtained by using the appropriate end sections. The knife head is chosen according to machine model and drive system.

### Easy use

- The sectional knives are delivered **fully assembled** for convenient replacement
- **The maximum transport length** of one section is 2.60m
- **Outstanding durability** thanks to tempered connector bars
- Galvanized blades for **high-quality protection from corrosion**
- Available **with and without knife head**

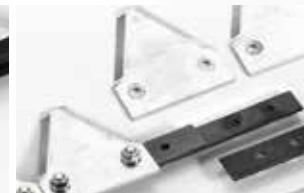

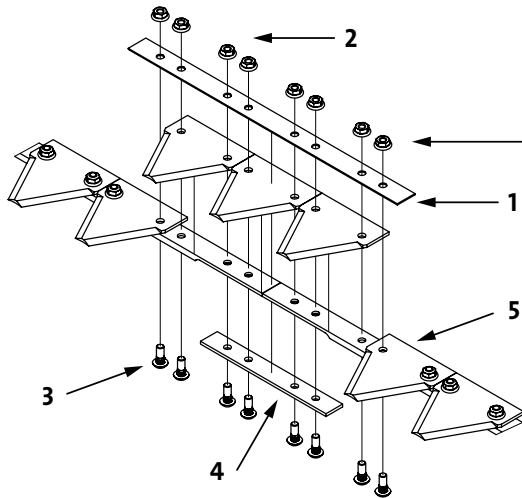

15 Nm - 18 Nm

## Knife connection kit

- (1) Stiffener
- (2) Flange nut M6
- (3) Torx screw M6x16
- (4) Connector
- (5) Section

## Easy use, reliable operation

- Easy assembly
- Connection kits are custom-fit to individual makes and types of sections
- The sectional knives are supplied complete with the necessary number of kits





The **radura® knife sections** are induction hardened for long-lasting sharpness and durability. Made from high-tensile steel,

the sections offer superior resistance to breaking around the holes. Each section has an anti-corrosive paint coat.

### Various serrations available

- Top serrated, bottom serrated, smooth edge
- Fine, coarse or extra coarse serration

### Attachment

- Bolted
- Riveted

### Super-fast assembly

- Bolted sections are quick and easy to fit
- Galvanized surfaces offer effective protection from corrosion



## The radura® guards



Changing climates and cropping schemes make higher demands on the cutter bar and its components. Professional farmers rely on high-quality wear parts that help

them use their machine to potential and ensure dependable operation. **radura® guards** are first-class spare parts that maximize the potential of your combine.

- **High stability** forged parts
- **Precision fit** for quiet running and clean cuts
- **High resistance** to wear from special materials and tempering methods
- **High-quality** black powder coat finish offers effective **protection from corrosion**



## The radura® knife heads



**radura® knife heads** transmit the drive power to the cutting system. Available in various designs, **radura®** offers the right head for every knife.

### **Knife heads are key for the performance of the cutting system**

- **Precision-fit** connection between the drive and the knife
- **Extremely quiet** knife operation
- **Perfect transmission of the power flow**
- **High-quality materials** for a long service life



## The radura® straw chopper blades



It is the cutting edge of a straw chopper blade that is exposed to the highest degree of wear. As a result, they round off and become dull. Cold rolled steel and induction hardened edges make **radura®**

**straw chopper blades** hard wearing and durable. Manufactured to exacting weight tolerances, these blades provide extremely smooth operation.



## The radura® straw chopper blades – High-Performance

The **radura® hard-faced blades** are available as an option for all common high-capacity combine harvester models.

- On a **radura® hard-faced blade** the back has a harder surface than the top face (beaver teeth effect)
- This leads to a cutting edge that does not lose its sharpness
- For a consistently high quality of chop
- Extremely wear resistant
- **radura® paddle knives** are twisted – a design that provides a uniform distribution of air and material

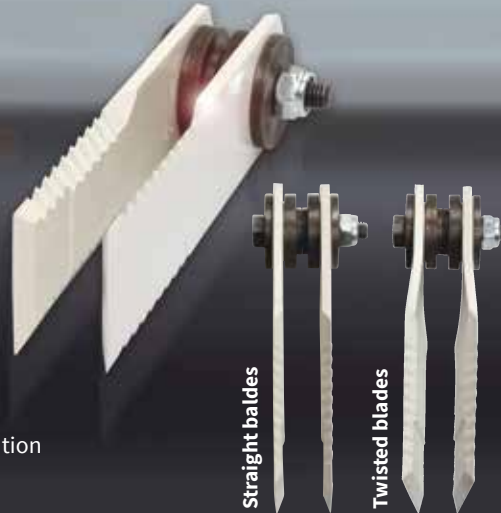

## Longer service life



### Standard: Straw chopper blades

Induction hardened  
(cutting edges only)



Edges begin to round off  
due to wear

### radura® Hard-faced blades

The bottom face of the  
blade is harder than the top face

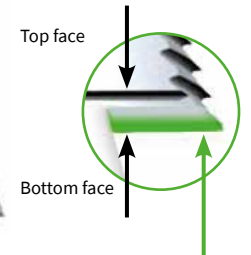

The cutting edge stays sharp  
and unaffected by wear

## The radura® straw chopper blade attachment



The straw chopper knives must be firmly seated to operate with precision. Therefore check the bushings regularly to ensure tight fit.

**radura®** offers suitable internal and external bushings for all versions of straw chopper blades.

### **Proper attachment ensures effective cuts and long-term service life**

- Wide variety of products
- Precision-fit bushings
- Secure fit
- Highest quality standards
- Easy replacement



radura® fits. Reliably.

radura® is multifaceted.  
radura® fits.  
radura® is safe.

GROUP SCHUMACHER

radura®

PARTS

Combine Harvesting

Grassland

Interactive product catalogue



The radura® online product finder

Whether for combining or forage harvesting – find your perfect-fit parts fast and easy with the **radura® product finder**.

#### How you do it:

- **radura.info**: Select your product from within the appropriate category – combining or grassland – and enter your machine type or product characteristics
- **radura.info** shows the suitable parts
- **radura.info** shows alternative options

All radura® parts are available at your agricultural dealer.

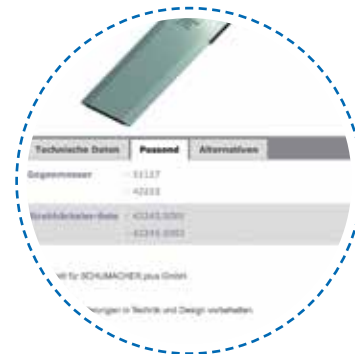

[www.radura.info](http://www.radura.info)



# Perfect Harvest.

## **SCHUMACHER GmbH**

Siegener Straße 10 . 57612 Eichelhardt / Germany

Phone +49 (0) 2681 8009 - 0 . [info@groupschumacher.com](mailto:info@groupschumacher.com)

[www.groupschumacher.com](http://www.groupschumacher.com)

